



2024

## PRINCESS F65

PÅ LAGER • F65020 • GBPYIW2012A424

VISNING COPENHAGEN, DENMARK

2X MAN V8 (2X 1300HP) - H  
TOPHASTIGHED, CA KN  
LÆNGDE 20.3 M X BREDDE 5.1 M  
5 KAHYTTER • 4 WC

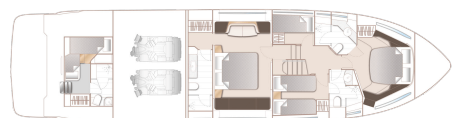
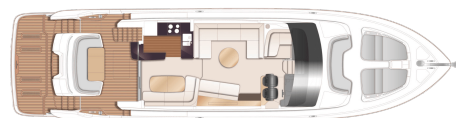
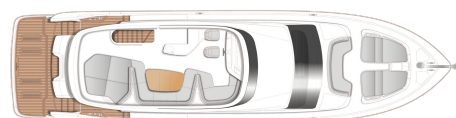

Princess Yachts West Sweden  
+46 (0) 304 390 90  
princessyachts.se

Princess Yachts Norway  
+47 66 76 08 70  
princessyachts.no

Princess Yachts Denmark  
+45 70 26 84 84  
princessyachts.dk

### PROPULSION

|           |            |
|-----------|------------|
| Motorer   | 2x MAN V8  |
| Motor     | 2x 1300 hp |
| Type      | Inboard    |
| Drifttype | Shaft      |
| Brændstof | diesel     |

### DIMENSIONER

|            |           |
|------------|-----------|
| Længde     | 20.3 m    |
| Bredde     | 5.1 m     |
| Dybt, ca.  | 1.63 m    |
| Weight, ca | 40177 kg  |
| Brændstof  | 2x 4100 L |
| Vand       | 873 L     |
| Septic     | 1x272 L   |

### ANDET

|             |                         |
|-------------|-------------------------|
| Fabrikant   | Princess Yachts Limited |
| Designer    | Olesinski               |
| Bådkategori | Power                   |
| Skrog type  | Planing                 |
| Material    | Fibreglass              |
| El. system  | 24 V                    |
| Kahytter    | 5                       |
| WC          | 4                       |

Vi har en ny Princess F65 i København.

#### ENGINES & DRIVE

Twin MAN V8-1300 (2 x 1300mhp)

Variable speed bow and stem thrusters with Hold-function docking facility. (Note: Standard bowthruster is uprated to 210 KgF and a 170 KgF sternthruster is fitted) upgrade thrusters to new Evison

Third station controls in cockpit (engine controls and emergency stops, thruster controls)

#### STABILISATION

Sleipner Vector Fin stabilisation system with VF800 fins. When underway fins are driven by an engine powered hydraulic motor and at zero speed by a generator powered electric motor (19Kw generator also recommended)

#### HULL COLOUR

White Gel coat finish (with dark grey water line and black antifouling, hull and bathing platform fendering is white with stainless steel insert)

Radar arch injill panel and canopy stripe finished in graphite grey metallic paint, engine air vent cover and aft end saloon window in onyx black, Exterior furniture in finished in oyster grey meta/lie paint, where specified. Canopy styling blade is white gel coat as standard.

"Canopy graphic to canopy styling blade (note white gelcoat finish as standard) please choose one from selection below  
? Electric Blue"

#### INTERIOR FURNITURE

Walnut interior wood satin finish (galley and helm footrest are planked walnut)

"Timber flooring to aft dining area (as per galley ) in V-groove planked walnut"

Standard helm console is Grey with helm seats in Putty leather

## LAYOUT

"Aft Cabin Fit out (B)

with twin bunks (two staggered single berths, wardrobes with shelves, separate toilet & shower). Furniture in specified choice of boat timber with fitted carpet. Includes transom glazing"

Starboard cabin inboard berth to have electrically powered sliding mechanism to convert to double berth

Pull out table to companion L-shape seating area adjacent to helm

## STYLING

Elevate the overall styling and ambiance of your yacht with design elements selected exclusively from the Design Studio Collection:

"Allure Collection (excl hardtop):

Interior styling includes:

Quilting detail with contrast accents and rear timber panel (to match boat timber) to main helm seats

Exterior styling includes:

Quilting detail with contrast accents to flybridge helm seating

-Teak step nosing upgrade (including transom, flybridge, foredeck and steps to side deck when side deck option is selected)

-Exterior lighting upgrade package (includes additional deck level lights on side decks and transom, flybridge deck wet-bar & bathing platform)

-Cockpit servery finished in Oyster Grey metallic

-Flybridge console finished in Oyster Grey metallic

-Flybridge wet-bar finished in Oyster Grey metallic

-Exterior upholstery in Comfort Exterior III Met Ice with Met Macadamia contrast detailing

-Underwater transom lights (4 Lumishore SMX53 Blue/White)

-Underwater lighting to aft hull sides (2 per side Lumishore SMX53 Blue/White)

-Pininfarina/Isotta steering wheel at both helm stations

-Princess Crown logo in bathing platform teak"

## GALLEY

"Galley worktop including cockpit bar top are Sylmar Solid Surface white as standard to match the bar top"

## BATHROOMS

Bathroom worktops are in White Solid Surface (satin finish) with thermoformed wash basins with Solid Surface Carrara White (satin finish) floors

Cabinets in specified choice of boat timber with chrome bathroom hardware as standard

Heated floors in WC

## COLOUR SCHEME

Colour scheme can be selected from the Quartz VII or Milan IX range of fabrics as standard

Putty leather in dining sofa and passenger sofa

Premium Carpet London Elements Symphony Paris

Saloon sofa/Master stateroom sofa/Bedheads: Fugace 4217 02 14

Bedcovers: Arizona E252 38 27

"Scatter cushions:

4x Fugace 4213 02 14 50x50cm

4x Burlington String 50x50cm

6x Burlington Tan 50x50cm"

Additional charge for quilted blankets and linen  
Loose runner in dinette and saloon gangway (200292)

#### DECK HARDWARE

Up/down electro hydraulic transom platform with 550Kg SWL capacity fitted as standard with stainless steel keyway plates and slider system on platform  
GRP Flybridge hardtop featuring electric opening section in soft fabric and including lighting with dimmer  
Electrically operated sun awning to aft end of hardtop  
Teak decking to cockpit and bathing platform, fitted as standard  
Teak laid flybridge deck 6mm  
Teak laid side decks, seating area & foredeck 6mm  
Foredeck teak coffee table with deck mounted fixing point  
Electro-hydraulic telescopic passerelle (4m) with automatic hand rails  
Electric stern rope handling winches (2)  
Side boarding doors to cockpit area  
Stainless steel Epsilon anchor ( 40kg), with stainless steel swivel in place of standard  
Additional 20m of 10mm anchor chain to give a total of 80 metres  
Stainless steel keyway plates for later fitting of tender slider system on bathing platform  
Chain counter on fore windlass at helm

#### GENERATOR

Whisper M-SQ PRO 22.5kW generator

#### ELECTRICAL

Continental 220v/240v sockets  
Dishwasher fitted in galley (slimline – 9 place setting)  
Icemaker in saloon  
Fit heated towel rail in bathroom  
"Interior lighting upgrade package  
Concealed LED strip lighting to starboard and port sofa base surround"  
Raymarine Rear facing day and night network dome marine camera to be displayed on helm MFD screens.  
Raymarine camera in engine room to be displayed on helm MFD screens.  
(107566) Fit additional batteries (4)  
(107619) Supply and fit inverter for galley sockets (for small Nespresso coffee machine) and TVs (only to be ordered in conjunction with additional batteries)  
Shorepower cable incl adapter

#### AUDIO VISUAL & COMMUNICATIONS

##### "STANDARD AUDIO/VIDEO SYSTEM

Deck Saloon – 55?" LED TV on power lift mechanism with Fusion Apollo MS-RA770 AM/FM/Bluetooth/DAB/WIFI with external USB, Paired with Focal speakers (2)  
Owners Stateroom – 43?" LED TV. Fusion Apollo MS-RA770 AM/FM/Bluetooth/DAB/WIFI with external USB. Paired with Focal speakers (2)  
Flybridge – Fusion Apollo SRX-400 Radio/Wi-Fi/Bluetooth with waterproof Fusion speakers (2)  
Includes 2 x Fusion ARX-70 wireless remotes in black (supplied loose for later fitting)"  
Forward Cabin TV & Audio Package – 43" LED TV with Fusion Apollo MS-RA670 with DAB and external USB. Paired with Focal speakers (2)  
Upgraded fwd stereo to RA770  
Cockpit Audio Package Fusion ERX400 remote control with Waterproof Fusion speakers

(2) linked to saloon audio system

#### NAVIGATION

"Standard navigation equipment incorporates:

Lower helm:

Raymarine Axiom XL 16 (15.6") multifunction colour display, incorporating GPS/chart plotter, log and echo sounder. Raymarine Evolution autopilot with P70Rs control head also fitted. In addition, engine instrumentation (including fuel levels and fuel flow) is displayed on a 9" multifunction display.

Upper helm:

Raymarine Axiom XL 16 (15.6") multifunction colour display, incorporating GPS/chart plotter, log and echo sounder. Raymarine Evolution autopilot with P70Rs control head also fitted. In addition, engine instrumentation (including fuel levels and fuel flow) is displayed on a 9" multifunction display."

Second Raymarine Axiom XL16 (15.6?) colour multifunction display at upper helm

Second Raymarine Axiom XL16 (15.6?) colour multifunction display at lower helm

Raymarine Cyclone HD colour radar, 4kW pedestal with 48? open array scanner

Raymarine AIS 700 Class B transponder interfaced with chartplotter

Raymarine Ray 90 Dual Station VHF

(107620) Remote for autopilot

Sjökort Navionics XG45

#### AIRCONDITIONING / HEATING / DEMIST

"Reverse Cycle Airconditioning/heating (104,000 BTU) suitable for temperatures to 40°C (tropical) With controls in all cabins and outlets in all areas (including bathrooms)

Recommended generator : 19 Kw"

Aft cabin airconditioning Condensing unit 8,000 BTU supplying 8,000 BTU unit (with SMX control)

Windscreen demist system using warm air heater powered from calorifier

#### MOSQUITO SCREENS

Mosquito screens for all opening portlights

#### HOLDING TANK / TOILETS

Electric discharge of holdingtank

#### EXTERIOR UPHOLSTERY / CANVAS / COVERS

Cockpit, Foredeck & Flybridge upholstery including helm seats – Comfort Exterior III

Vogue Eucalyptus with Vogue Earth contrast

Foredeck sunbeds to have manually adjustable head rests and back rests (to provide aft facing seating to complement U-shaped seating area) , in lieu of standard, fixed sunbeds

"Fit reticulated foam to all standard exterior cockpit, foredeck and flybridge seating/sunpads in place of standard"

Exterior covers – Grey

(200135) Supply separate grey cover for optional foredeck table

(200136) Supply separate grey cover for cockpit sofa

#### ACCESSORIES

8 place setting of China, Cutlery & Glasses are supplied as standard

Oplysningerne om denne båd gives i god tro og antages at være nøjagtige, men kan ikke garanteres. En køber eller hans inspektør skal undersøge de detaljerede betingelser, som køberen ønsker at validere. Vi forbeholder os ret til at foretage ændringer eller at båden ikke længere er til salg.



Princess Yachts West Sweden  
+46 (0) 304 390 90  
princessyachts.se

Princess Yachts Norway  
+47 66 76 08 70  
princessyachts.no

Princess Yachts Denmark  
+45 70 26 84 84  
princessyachts.dk