



2023

## PRINCESS S72

FORMIDLING • S72515 • GBPYIF6037F323

SKIBET ER REGISTRERET I SVERIGE  
VISNING BOHUS-MALMÖN, SWEDEN

2X MAN V12 (2X 1800HP) - 445H  
TOPHASTIGHED, CA 37KN  
LÆNGDE 23.09 M X BREDDE 5.45 M  
5 KAHYTTER • 4 WC

SOLD

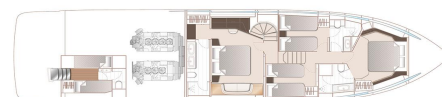
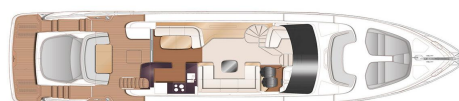
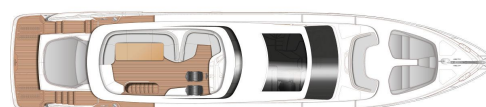

Princess Yachts West Sweden  
+46 (0) 304 390 90  
princessyachts.se

Princess Yachts Norway  
+47 66 76 08 70  
princessyachts.no

Princess Yachts Denmark  
+45 70 26 84 84  
princessyachts.dk

### PROPULSION

Motorer	2x MAN V12
Motor	2x 1800 HP
Hours	ca 445 H
Hastighed, ca.	37 kn
Type	Inboard
Drifttype	Direct
Brændstof	diesel

### DIMENSIONER

Længde	23.09 m
Bredde	5.45 m
Dybt, ca.	1.72 m
Weight, ca	48927 kg
Brændstof	4500 L
Vand	820 L
Septic	1x400 L

### ANDET

Fabrikant	Princess Yachts Limited
Designer	Olesinski
Bådkategori	Power
Material	Fiberglass
Kahytter	5
WC	4

**EU MOMS BETALT 2023 PRINCESS S72 TIL SALG (sammenlignelig pris ekskl. 25% moms: €3.120.000)**

### ÅBEN FOR INBYTTE • PRINCESS TEKNISK ORIENTERING INKLUDERET

To MAN V12-1800 (2 x 1800 mhp) dieselmotorer • Hvid gelcoat finish • Valnød interiørtræ, satin finish • Fire kahytter med plads til 8 gæster, plus besætningskahyt • Yacht Controller • Hydrauliske bov- og hækpropeller med variabel hastighed • Hydrauliske finne-stabilisatorer • Omvendt cyklus aircondition • Onan generator 27 kW • Opgraderet belysningspakke • Elektrisk betjent skydetag over forreste salonområde • Elektrisk-hydraulisk bimini • Raymarine navigationsudstyr • Undervandslys

### KONTAKT OS VENLIGST FOR SPECIFIKATIONER OG MERE INFORMATION OM DENNE PRINCESS S72 SPORTSBRIDGE TIL SALG

#### FULL SPECIFICATION FOLLOWS

#### ENGINES & DRIVE

Twin MAN V12-1800 (2 x 1800mhp)  
Yacht Controller Dual Band

#### HYDRAULICS

Hydraulic system consisting of separate engine driven hydraulic pumps allowing any system to be supplied with hydraulic power from either engine. Including hydraulic anchor winch and 320kgF hydraulic bow thruster (in place of standard) 240kgF stern thruster and hold function docking system. All with dual station controls

#### STABILISATION

Sleipner Vector Fin stabilisation system with VF800 fins. When underway fins are driven by an engine powered hydraulic motor and at zero speed by a generator powered electric motor. (NB Variable speed thruster(s) are recommended as fin and thruster controls are incorporated into one control at both helms (Recommended fitment of upgraded 27kW generator for this option)

## HULL COLOUR

Engine air vent cover in white GRP with graduated vinyl fade to black. Deck house buttresses, cockpit headlining, styling undercut of radar arch and canopy forepeak finished in graphite grey metallic paint. Top side of radar arch in white GRP White (with dark grey water line, black antifouling, hull & bathing platform fendering is white with stainless steel insert)

## INTERIOR FURNITURE

Galley lower units are in boat timber. Top lockers are in Taupe Grey laminate finish Walnut interior wood satin finish (galley, dinette and helm floors are V groove planked walnut as standard)

Standard helm console is Grey with helm seats in leather

Replace saloon table with Calcutta Oro Marble top and base in satin walnut

Dinette table with Majilite Prestige Sand fabric instead of Dekton dark inlay

Supply two Savoy Dressing table chairs to dinette

## LAYOUT

Single Saloon armchair, with drawer beneath, incorporated into port side sideboard unit

Flip up arm rests to lower helm and navigators seat (2 per seat)

One berth in crew cabin

## GALLEY

Galley worktops, bar and cockpit servery finish is solid surface as standard: Carrara White

## BATHROOMS

Bathroom cabinets are finished in slate grey veneer as standard

Vanity tops are Sylmar White Solid Surface (satin finish) with thermoformed basins

Floors are Carrara White (satin finish) as standard

Bathroom splashbacks Carrara White

## COLOUR SCHEME

Colour scheme selected from the Quartz VIII or Milan IX range of fabrics

Square quilted Blankets with linen

Bespoke helm seat design

Upgrade to Elements Symphony Paris carpets

Loose carpet lower helm

Loose cushions and throws

Upgrade cockpit sofas fabric

Light leather on passenger sofa backrest saloon

Top bed mattress in master stateroom and fwd cabin

## DECK HARDWARE

Note: The Princess S72 has an up/down electro hydraulic transom platform with 550Kg SWL fitted as standard. (maximum recommended tender weight is 450kg)

Teak laid cockpit, sportbridge deck, transom platform and steps to sportsbridge are standard on this craft

Teak laid side decks and foredeck walkthrough

Electrically operated sliding roof over forward saloon area (incorporating standard skylights with electric blinds)

Remote control 4.1m telescopic passarelle with folding handrails

2 x folding dining chairs for use at cockpit table

Side boarding gates to aft port and starboard side decks  
Standard anchor is 50kg Delta anchor with 60m of 12mm chain  
Stainless steel Epsilon anchor in place of standard (50Kg)  
Additional 40m of 12mm anchor chain to give a total of 100 metres  
Teak coffee table for foredeck seating area (with fixing point)  
Deck wash system, located in transom, foredeck and sportsbridge lockers  
Top loading cool box unit to cockpit bar unit  
L-shaped aft facing cockpit seat in place of port servery unit (Fabric selection to match cockpit upholstery)  
Chain counter for fwd windlass (per helm)  
Stainless steel ladder for side doors

#### GENERATOR

Primary generator upgrade ONAN 27 kW/50Hz

#### ELECTRICAL

Continental 220v/240v sockets

“Power socket upgrade

- Upgrade single sockets in forward cabin to doubles (x2)
- Additional single socket with twin USB in port cabin
- Additional single socket with twin USB in starboard cabin
- Additional single socket in master stateroom
- Additional double socket in aft/crew cabin
- Qi wire/less charging pad on sportsbridge helm
- Qi wire/less charging pad aft of foredeck seating”

Underwater transom lights (4x Lumishore THX 803 full colour interfaced with Radar/Chartplotter MFDs)

“Heated towel rail in bathroom (each – specify bathroom to be fitted) (Not available in crew bathroom)

- ? Master Cabin
- ? Forward Cabin
- ? PortCabin”

“Under floor heating in bathrooms ( each – specify location, excludes shower areas) (Not available in crew bathroom)

- ? Master Cabin
- ? Forward Cabin
- ? PortCabin”

Separate washing machine and condenser dryer machine located below stairs leading to Master Stateroom lobby (in place of standard washer/dryer)

“Interior lighting upgrade package

Additional fibre optics (to saloon & dining area) Additional LED strip lights to blind pelmets – to lower accommodation”

“Exterior lighting upgrade package

Included linear LED (xl) and fibre optic lighting to the cockpit pelmet and headlining and low level LED dock lighting (x28)”

Electric blinds in lieu of manual Venetian blinds in master stateroom (does not include bathrooms)

Electric standard venetian blinds to all main deck windows, excludes patio door & helm area

Freshwater maker (190 litres/hour) with remote instrumentation and service/spares kit  
CCTV cameras (2 x fixed cameras in engine room, 1 x pan/tilt camera in cockpit)

230V socket in garage  
Inverter to socket in galley and TVs  
Shorepower cable and adapter

#### AUDIO VISUAL & COMMUNICATIONS

##### “STANDARDSYSTEM

Deck Saloon – 55” LED TV an power lift mechanism Naim Uniti Atom audio system with Bluetooth, multi-zone streaming capability and dedicated app. Paired with Focal speakers (2) and subwoofer

Owners Stateroom – 55” LED TV

Naim Uniti Atom audio system with Bluetooth, multi-zone streaming capability and dedicated app. Paired with Focal speakers (2)

Sportsbridge – Naim Uniti Atom audio system with Bluetooth, multi streaming capability and dedicated app. Paired with JL Audio waterproof speakers (2)

Cockpit seating area – Naim Uniti Atom audio system with Bluetooth, multi streaming capability and dedicated app. Paired with JL Audio waterproof speakers (2)

- On board Ethernet network and 4G internet capability
- On board WIFI network incorporating external WIFI and 3G/4G antenna for extended range. Enabling connectivity to onshore WIFI networks throughout the vessel. (Mobile internet connectivity requires an activated mobile data SIM card.) (Please note that SIM card is not supplied)”

#### NAVIGATION

“Standard navigationsutrustning:

Raymarine Axiom XLI 6 multifunction colour display (two at lower helm and one at upper helm) incorporating Radar/Chartplotter with GPS and 4kW SHD 48” digital colour open array scanner. Raymarine Evolution autopilot with rate gyro with p70Rs control heads and i70s multifunction instruments (for speed, distance, trip, depth alarm, water temp etc) also fitted at both helms”

“1 x 15” Boning display at each helm dedicated to Boning system, integrated with the following functionalities:

- Engine instrumentation (including fuel levels and fuel flow)
- Digital heat alarms
- Lighting controls
- AC/DC control & monitoring
- CCTV camera display”

Additional Raymarine Axiom XLI 6 colour multifunction display at upper helm

Remote control keypad (RMK-10) for multifunction display fitted at upper helm

Remote control keypad (RMK-10) for multifunction display fitted at lower helm

Raymarine Magnum HD colour radar, 12kW pedestal with 48” open array scanner

Raymarine Ray90 Multi Station VHF

Raymarine AIS Class B transponder interfaced with chartplotter

Stern camera connected to plotters

Navionics chart

#### AIRCONDITIONING

“Reverse cycle air conditioning/heating (split gas system, not chilled water): 128,000 BTU – Suitable for ambient temperatures up to 40°C (tropical specification) With controls in all cabins and outlets in all areas (includes outlets in bathrooms and crew cabin)

Recommended generator : standard 22.5kW generator is suitable (NB. This has sufficient capacity for Gyro stabilisers as well as air conditioning)”

Windscreen demist system using warm air heater powered from calorifier

#### EXTERIOR UPHOLSTERY / CANVAS / COVERS

Foredeck, cockpit & sportbridge seating with no contrast. Sunbed cushions with contrast insert in Comfort Exterior III Vogue with Vogue/Met or Hitch contrast

Fit reticulated foam to all standard exterior cockpit, foredeck, and sportsbridge seating/sunpads in place of standard ( to improve drainage, excludes helm seats)

Cockpit, foredeck and sportsbridge covers

Loose covers for cockpit sofas, sunbed and table

Bimini top – Grey canvas

Additional charge for Bimini top to have LED overhead lighting (switched from console)

Additional charge for Bimini to be electro-hydraulically powered

#### ACCESSORIES

8 place setting of China, Cutlery & Glasses

Upgrade to Silver line crockery

6X Fender socks – Grey with Princess Logo

Liferaft Ocean Safety Regatta 8 persons in a bag

Offshore flare pack

Two horseshoe boys

Oplysningerne om denne båd gives i god tro og antages at være nøjagtige, men kan ikke garanteres. En køber eller hans inspektør skal undersøge de detaljerede betingelser, som køberen ønsker at validere. Vi forbeholder os ret til at foretage ændringer eller at båden ikke længere er til salg.



Princess Yachts West Sweden  
+46 (0) 304 390 90  
princessyachts.se

Princess Yachts Norway  
+47 66 76 08 70  
princessyachts.no

Princess Yachts Denmark  
+45 70 26 84 84  
princessyachts.dk